

# news from the **EDGE**



First Presbyterian Church of  
**EDGEWOOD**  
The Community Church

Believing we are called together  
by God's love through Jesus Christ, our mission as  
the First Presbyterian Church of Edgewood is to  
love God, to love each other and to love our neighbors.

The monthly newsletter of the First Presbyterian Church of Edgewood

**January 2016**

**125**  
YEARS  
CELEBRATING  
1891 — 2016

## 2016 Marks FPCE Quasiquicentennial Year

Qua-what? The official term for a 125th anniversary is that very long word above - Quasiquicentennial. The year 2016 marks the 125th year that what is now First Presbyterian Church of Edgewood was founded back in 1891 as the Edgewood Presbyterian Church. Since that time, the congregation has gone through many changes. The first service took place in a building that no longer exists (where the current Paul Gates & Son Auto Service stands). The first church building was constructed on the current property, but looked very different from the building we know and love today, since it was expanded in 1917 to include our

beautiful sanctuary. Over the years, the membership grew to be over 1,000.

In 1983, the First Presbyterian Church of Wilkinsburg merged with the Edgewood Presbyterian Church to become the First Presbyterian Church of Edgewood. In January 2007, we welcomed the members of the Mulberry Presbyterian Church into our fold, adding to our role as the "community church."

Now, we turn our attention to the future...building renovations, programming ideas, ministry and mission decisions. As we celebrate 125 years together, let us challenge ourselves to think about how we can make that number a driving force in our life as a congregation. Is it a goal of 125 worshipers on Sunday morning? 125 new faces at our community meals? 125 phone calls made to friends and families inviting them to a program, event, or service? 125 hours put in toward a mission project? \$125 donated to the building renovation project? What will "celebrating 125 years" mean to us as a congregation? God has blessed us with a rich 125 years of history - let's work to start the next 125 in new and exciting ways!

## January 2016 Worship Schedule

### January 3

What were the Magi looking for? Their story is told in Matthew 2: 1-12 and prophesied in Isaiah 60:1-6. Begin the new year with us as we celebrate the Sacrament of Holy Communion.

### January 10

We will celebrate Justice Sunday. It's where our faith meets the real world— in real life. The Lord's Supper we celebrated last week should have an impact on the way we live and move and have our being in the world.in the real world.

### January 17

EMERGING WORSHIP SUNDAY! We will be ordaining and encouraging the newly elected Elders, Deacons and Nominating Committee members into their service. Join us!

### January 24

The powerful lessons from Luke 4:14-21 and I Corinthians 12: 12-31a teach us a vital lesson. The church has a purpose and in order to fulfill that purpose—we need one another!

### January 31

This is a Sunday service you will not want to miss. We are going to talk about the one gift that is the greatest gift of all. A congregational meeting will follow—what will our building renovation look like?



## STAFF DIRECTORY

120 East Swissvale Avenue  
Pittsburgh, Pennsylvania 15218  
Phone: 412-241-4613  
www.fpcedgewood.org

### Pastor:

The Rev. Michael P. Rucker  
mprucker@fpcedgewood.org

### Pastor Emeritus:

Dr. Gerald Hollingsworth

### Student Pastor:

Jeff Nine  
jeffrey.nine@westernsem.edu

### Minister of Music:

Shaun Cloonan  
music@fpcedgewood.org

### Organist & Pianist:

Sunny Sakai  
sunnysakai4@gmail.com

### Section Leaders:

Tyler McGuigan  
Mandy Rineer

### FROGS Director & Office Manager:

Judy Mysels  
frogs@fpcedgewood.org  
office@fpcedgewood.org

### Building Manager:

Rob Mysels  
building@fpcedgewood.org

### Office Hours:

Monday–Friday  
9:00AM–2:00PM

News from the Edge is the monthly newsletter of the First Presbyterian Church of Edgewood. If you have information you would like to include in the next issue, email Judy Mysels at office@fpcedgewood.org by the 15th of the prior month. Sponsorship is available for \$40 per month.

# PASTOR'S POINT OF VIEW



Michael P. Rucker  
Pastor

## HAPPY NEW LIFE!

There are no calendars in heaven. God does not have January 1 circled. The eternal God does not mark the passage of time. God does not need to be on time for anything (I'm jealous!) Instead, God redeems time—all of the time. God longs to redeem you and all of creation—*all of the time*. To God, every day is new year's day. Happy New Year does not make sense in the eternal world. HAPPY NEW LIFE for you, me, this congregation, this community, and this world does make sense. According to our brothers and sisters around the world and throughout history, God is longing to break into our lives to heal, redeem, comfort, direct and encourage us. God's mission is to give us and all people a new life.

**"Behold, I am making all things new.  
Write it down! For these words are  
trustworthy and true." (Revelation 21:5)**

This whole redemption thing works best if we cooperate with it. If we yield to it. If we long for it.

For instance, my son, Desmond, is nearly 15 years old. (Yikes! Already?) And, as is true for every 15 year old boy and girl you have known, the head, heart, hormones and emotions splay themselves across every day. Young teens are discovering how challenging and unrelenting the demands of life can be. So, each day I am able to be with him, I give him as big a hug as he will allow, urge him to focus on the good things he is learning, the good friends in his life, and the good thoughts that ramble through his mind. And while he is at it—try to have as much fun as he can.

Trust the message of Christmas—Emmanuel! God is with us through our growing, our striving, our crying, our laughing. Yes, life can be difficult. But throughout it all—God wants us to in joy all of the time.

**"...our mouth was filled with laughter  
And our tongue with shouts of joy."  
(Psalm 126:2)**

HAPPY NEW LIFE, EVERYONE!

*Pastor Michael*

# Officers Elected at December Congregational Meeting

At the December 2015 congregational meeting, the slate of nominees for church leadership was presented and voted upon. The following members have been elected to the church councils and positions of leadership. An asterisk (\*) indicates second consecutive term for the individual listed. New Deacons and Ruling Elders will be ordained to office, and returning members will be installed for a new term during our worship service on January 17. Session and Deacon terms are for 3 years, auditors and nominating committee members are for 1 year appointments.

## Session Class of 2018

Lorraine Douthett

Nancy Ernst

(two more elders to be elected)

## Deacons Class of 2018

Mary Ann Hartman

Ed Masten

Rick Masten

Helen Ebken

Dana Breakwell

## 2016 Nominating Committee

Judy Mysels

Mary Ross

Lisa Segedy

Appointed Session Member

Appointed Deacon Member

## 2016 Auditor

TBD

## Per Capita

The Westminster Confession of Faith says, “all believers are, therefore, under obligation to sustain the ordinances of the Christian religion where they are already established, and to contribute by their prayers, gifts, and personal efforts to the extension of the Kingdom of Christ throughout the whole earth” (*The Book of Confessions*, 6.058).

Per capita is a fundamental way in which all of the nearly 11,000 congregations and mid councils of the Presbyterian Church (U.S.A.) are connected and participate in the work of the wider church.

Because it is rooted in the connectional and covenantal nature of the Presbyterian church, as affirmed by the ordination vows taken by elders and ministers of the Word and Sacrament, per capita could be called the Presbyterian Covenant Community Fund.

Why is per capita important? Per capita brings Presbyterians together — literally!

Presbyterians are connected in many ways, including our church government. We believe we discern best what God is calling us to do when we gather as mid councils, “seek[ing] together to find and represent the will of Christ” (*Book of Order F-3.0204*).

Per capita dollars pay for the costs of holding a General Assembly — including paying for the travel, room and board of commissioners and advisory delegates, several of whom would not be able to afford these expenses on their own.

Per capita makes it possible for Presbyterians to govern ourselves the way we do. Presbyterians have a form of government built upon shared power and mutual accountability as we seek together to find and represent the will of Christ. By providing the primary means through which commissioners and advisory delegates can gather to do their work, per capita dollars help to undergird our governance system.

Our Constitution provides a moral and theological compass that builds community and calls us to Christian faithfulness in gratitude to God. Per capita makes possible our effort for visible unity of the church of Jesus Christ. The PC(USA), as with other faith traditions and denominations, is but a small part of the one church of Jesus Christ. We affirm that God’s call is for the church to be one.

Per capita makes it possible for us to maintain our historical awareness. Our historical heritage helps us make informed decisions for the future. The Presbyterian Historical Society is our national archives and historical research center. It collects, preserves, and shares the history of the American Presbyterian and Reformed tradition.

**The per capita rate for 2016 has been set at \$29.10 per FPCE member.**





## F.R.O.G.S. News

Friends, Reading, & Other Great Stuff

Judy Mysels

FROGS Program Director

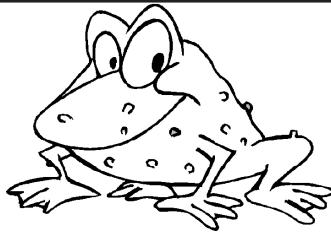

December has been a short, but very busy time for FROGS. We made cards to accompany the poinsettias the Deacons delivered, and we made other ornaments and gifts for FROGS parents/etc.

I would like to take this time to really thank the volunteers that really run the FROGS program: Dan Mielke for picking up the dinner daily and being "Mr. Crafty"; Ruth Miller and Connie Black for making delicious dinners from the food picked up at WCM and helping where/when needed; Mary Ross for always thinking about the kids and their activities and buying special kits for them to work on; Rick Masten for being the football/quarterback man trying to teach the kids the game, sportsmanship, rules, etc. and for bringing in those yummy powdered donuts the kids love so much and for giving them a holiday scavenger hunt; Ed Masten for his homework expertise and hugs/special attention given to the kids; Ranger Tim for sharing stories, experiences with the kids; Sallie Monk for her help in the kitchen, with snacks, crafts, homework and all over devotion to the kids; and of course, Flo Raisig, for her expertise in handling the kids, teaching skills, giving much appreciated advice, working closely with special ones. All the volunteers are precious to the program and go above and beyond whatever is asked of them.

Special thanks to Lisa Segedy for sharing her storytelling talents, giving a special holiday treat to the kids on Dec. 17.

Continued thanks for all the delicious donations for snacks. Please continue to remember needed drinks, etc. starting in January.

The FROGS program is enjoying the holiday break and will resume on January 5 . Happy Holidays and may you all have a special, healthy 2016...



It is certainly a busy time of year for everyone, and we would like to say thank you for taking the time to purchase all the wonderful gifts for the Angel Tree. I know these families and Action Housing are grateful for all the donations.

A big thank you to Shadyside Academy for almost 3,000 items for our Food Pantry, which has been used quite often the last few months. Below see a picture of the 2nd graders after bringing their donations to FPCE.

Harvest Baskets and poinsettias were delivered to our Friends of the Church during the holiday season. A special thanks to FROGS for the cards that accompanied them. Our friends of the Church are all so grateful that they are in our thoughts and prayers. Please keep in touch with them; they would love to hear from you!

We hope to see all of you at the Congregational Luncheon on January 31 for wonderful fellowship and a wonderful meal of wedding soup and Triangle Hoagies.

To You and all you hold dear,  
A Blessed Christmas  
and a Happy New Year—  
*Mary Ann Hartman, Moderator*

## Offering Envelopes

Boxed 2016 envelopes are available at the side and front entrances of church. They can also be mailed to you.

### Offering Envelopes

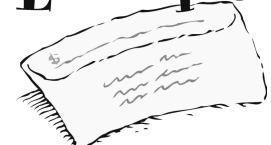

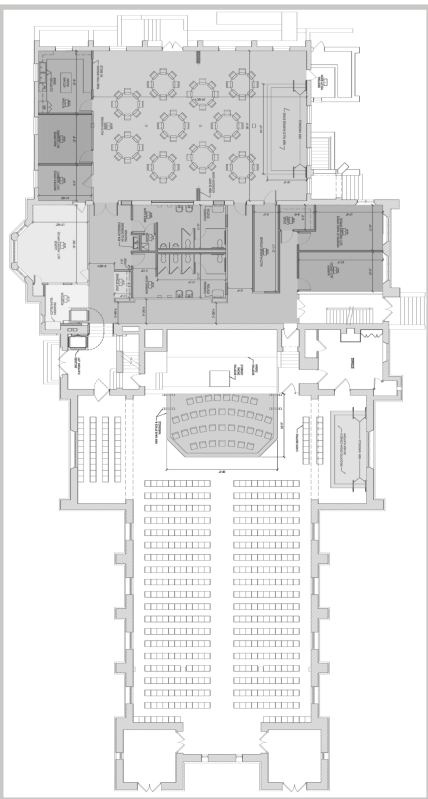

## MARK YOUR CALENDARS FOR THE 2016 ANNUAL MEETING ON JANUARY 31!

### Call for 2015 Reports

On Sunday, **January 31** immediately following worship, the Annual Meeting of the Congregation will be held to receive the 2016 budget and annual reports of the various ministries of the church.

If you are the staff member, chair or secretary of a ministry team or organization within the church, please have your narrative report into the church office by **January 19**. It can be given in hard copy or e-mailed as an attachment to Judy Mysels at [office@fpcedgewood.org](mailto:office@fpcedgewood.org).

### The Renovation of FPCE

What will we look like?? After our January 31 worship service, we will convene one of the most important congregational meetings in recent history. Our architectural firm, *LAMI GRUBB ARCHITECTS, LP.*, will be with us to present a PowerPoint representation of what our renovated church space would look like if we decide to proceed with such renovations. I HOPE VERY MUCH THAT EVERY ACTIVE MEMBER CAN BE PRESENT!!!

—Pastor Michael

## **BLOCKS** Believing Little Ones Can Know & Serve!

- Does your baby cry?
- Does your toddler insist on shouting his or her newly learned words at the most inappropriate times?
- Is your preschooler, shall we say, “spirited”?

Those of us who are caregivers for young children know—the answer to these questions is almost always, “Yes, of course.”

And for all those guardians who have faced the staring, gawking, disapproving, “tsk-tsking”, head-shaking, “Back in my day”-saying people at the grocery store as their child makes yet another scene, let us thank the Lord, indeed, for the words of Matthew: “Do not judge, or you too will be judged.”

FPCE is a place to go where all are welcomed...including energetic children. BLOCKS, in particular, is an especially inviting program for young children (and always judgement-free!).

Babies, toddlers, preschoolers, and their caregivers are encouraged to join us for our next BLOCKS session on Tuesday, January 19<sup>th</sup> at 6:30 in the Gathering Place. Following the themes of Martin Luther King, Jr. Day, we will learn together about “service”. Even our youngest disciples have a role to play in serving God, our church, and our community.

*(In case of inclement weather, email [EmilySLilly@gmail.com](mailto:EmilySLilly@gmail.com) before 5:30 to check if BLOCKS has been canceled.)* Please spread the word to your family and friends with little ones. Don’t let your fear of your child’s “church behavior” deter you. We welcome jumpy legs, off-key singing, and distracted wanderers. Truly, there is a place for all at FPCE!

### “Un-hanging of the Greens” Set for January 3

You know how beautiful the sanctuary looks during the Advent/Christmas season? It’s because of the dedicated work of our faithful “worker bees” each year right around Thanksgiving who stay after worship to make it happen.

Well, one of the things that sometimes gets forgotten is how to *take it all down* in a nice, orderly fashion. Many years it falls to Judy to do over the course of a week in between her normal office duties.

Please help us by sticking around after worship on **Sunday, January 3** to “un-hang” the greens and put everything away neatly. “Many hands make light work.” Thanks in advance!



Shaun Cloonan  
Minister of Music

# MUSIC Ministry

You all did it again — you showed your Edgewood hospitality! At the beginning of December, we welcomed the annual holiday concert of the Edgewood Symphony Orchestra in collaboration with the Renaissance City Choirs. The church was filled with music for their Tuesday night rehearsal as singers worked in the Gathering Place while the players rehearsed in the Sanctuary before putting it all together. As usual, it was a full house for the concert. Thanks to Jim Segedy for continuing his work not only as a member of the ESO (with a cameo as a certain bearded jolly elf conducting!), but as the go-to guy for site needs.

Then again, on December 13 our music ministry hosted my “kids” - the North Hills Singers - in worship and for a mini-concert after. It was a beautiful service and morning filled with singing and sharing in fellowship. Thanks to the Sanctuary Choir for organizing the meal in the Gathering Place afterward.

We had a wonderful Advent season and I’m thankful for each and every member of our music ministry for their contributions. A special shout-out to Sunny & Tyler for their leadership on Christmas Eve...lots of singing during that service!

As we move into the new calendar year, we’ll get back into our regular routine of classic & emerging worship, and as always, we’re looking for extra voices in the choir. Join us at 9:30 Sunday morning if interested!

## Men's Group

Come and join us each 7:00PM every 2nd and 4th Monday at Foli's (1050 Brinton Road) for a great time of food, fun and fellowship with like-minded Christian guys. We talk about all sorts of things. If you want a place to chat and have fun with other guys in the church just meet us there. No appointment necessary. Contact Jeff Nine if you have any questions.



## Tuesday Book Club

The weekly book club meets every Tuesday at 10:00AM. WE WILL BEGIN AGAIN starting January 5th. Come join us!

## Wednesday Night Bible Study

We meet each Wednesday from 7:00-8:00PM in the lounge. Good people. Great discussion. Join us!



# The Bulletin Board

*Sharing in the joys and concerns of our family & friends at FPCE*

- The congregation experienced a joyful and uplifting morning of song, when the North Hills Singers, directed by Shaun Cloonan, sang during the worship service on December 13. A lovely and fun choral concert followed the service. Thanks also to the FPCE choir members for providing a tasty lunch for the students afterward in the Gathering Place.
- Thanks to Ruth Miller, Florence Pickels, and Tina Nine for their time arranging the beautiful poinsettias on the chancel for Christmas Eve.
- Sympathies to the friends/family of Elizabeth Hand, who passed away on December 9.
- Many thanks to Tom Ochs for his hard work in getting the church a new security system to keep us safe!

# January

| Sunday  | Monday   | Tuesday  | Wednesday   | Thursday  | Friday                 | Saturday               |
|---|--|--|---|---|------------------------|------------------------|
| 3<br>9:30 Choir (C)<br>9:45 Adult Class (L)<br>11:00 Worship (S)<br><b>Communion</b><br>12:15 Fellowship (L)<br><b>“Un-Hanging of the Greens”</b> | 4<br><br>7:00 Scouts (SC)  | 5<br>10:00 Book Club (L)<br><br>3:45 FROGS<br><br>7:00 Deacons (L)<br>7:00 AA (SR)   | 6<br><br>7:00 Bible Study (L)                               | 7<br><br>3:45 FROGS                             | 8<br><br>8:00 AA (SR)  | 9<br><br>8:30 AA (SR)  |
| 10<br>9:30 Choir (C)<br>9:45 Adult Class (L)<br>11:00 Worship (S)<br>12:15 Fellowship (L)   | 11<br><br>7:00 Men's Group<br>7:00 Scouts (SC)   | 12<br>10:00 Book Club (L)<br><br>3:45 FROGS<br><br>7:00 Session (GP)<br>7:00 AA (SR) | 13<br><br>7:00 Worship Ensemble (S)<br>7:00 Bible Study (L) | 14<br><br>1:00 PW Circle (GP)<br><br>3:45 FROGS | 15<br><br>8:00 AA (SR) | 16<br><br>8:30 AA (SR) |
| 17<br>9:30 Worship Ens.<br>9:45 Adult Class (L)<br>11:00 Emerging (S)<br>12:15 Fellowship (L)   | 18<br><b>OFFICE CLOSED</b><br><br>7:00 Scouts (SC)   | 19<br>10:00 Book Club (L)<br><br>3:45 FROGS<br><br>6:30 BLOCKS (GP)<br>7:00 AA (SR)  | 20<br><br>7:00 Bible Study (L)                              | 21<br><br>3:45 FROGS                            | 22<br><br>8:00 AA (SR) | 23<br><br>8:30 AA (SR) |
| 24<br>9:30 Choir (C)<br>9:45 Adult Class (L)<br>11:00 Worship (S)<br>12:15 Fellowship (L)   | 25<br><br>7:00 Men's Group<br>7:00 Joy Circle (L)<br>7:00 Scouts (SC)  | 26<br>10:00 Book Club (L)<br><br>3:45 FROGS<br><br>7:00 AA (SR)                      | 27<br><br>7:00 Bible Study (L)                              | 28<br><br>1:00 PW Circle (GP)<br><br>3:45 FROGS | 29<br><br>8:00 AA (SR) | 30<br><br>8:30 AA (SR) |
| 31<br>9:30 Choir (C)<br>9:45 Adult Class (L)<br>11:00 Worship (S)<br><b>12:15 Cong. Mtg. Luncheon (SR)</b>  | <p style="text-align: center;">             C=Choir Room   GP=Gathering Place   L=Lounge   O=Office<br/>             PS=Pastor's Study   S=Sanctuary   SC=Scout Room   SR=Social Room           </p> <p style="text-align: center;"> <b>HAPPY</b> <i>New Year</i> </p> |  |   |   |                        |                        |



First Presbyterian Church of  
**EDGEWOOD**  
*The Community Church*

120 E. Swissvale Avenue • Pittsburgh, PA 15218

## Church History Hidden in the Lounge

Did you ever notice the plate in the display cabinet in the Lounge? This beautiful drawing of our church building is on the front, but hiding on the back is a brief history of the Edgewood Presbyterian Church. Take a look at what it says...



*Edgewood Presbyterian Church  
Pittsburgh, Pennsylvania*

After the incorporation of the Borough on December 1, 1888, the residents of Edgewood felt keenly the need of a place of worship. The Edgewood Presbyterian Church was organized December 17, 1891. Although we have worshipped in three buildings, we have only owned two. The cornerstone of the first building was laid on September 20, 1892, and the church was dedicated May 28, 1893. The new church furnishings were donated by the Dorcas Society and the organ by Mr. C. C. Mellor. In 1910 the Trustees renovated and extended the Sabbath School quarters in the basement of the church, but five years later the congregation expressed its desire for a new structure. Ground was broken on April 9, 1917, the cornerstone was laid on July 22, 1917, and the dedication services were held on November 17, 1918. Three days later the organ was dedicated. The total cost of the building, including the donated equipment and furnishings, was approximately \$150,000.00. The chimes, a gift from Mr. and Mrs. George C. Blackmore, were dedicated December 15 and 16, 1929.

*Rhythm*  
SOMER LAUGHLIN  
1929